

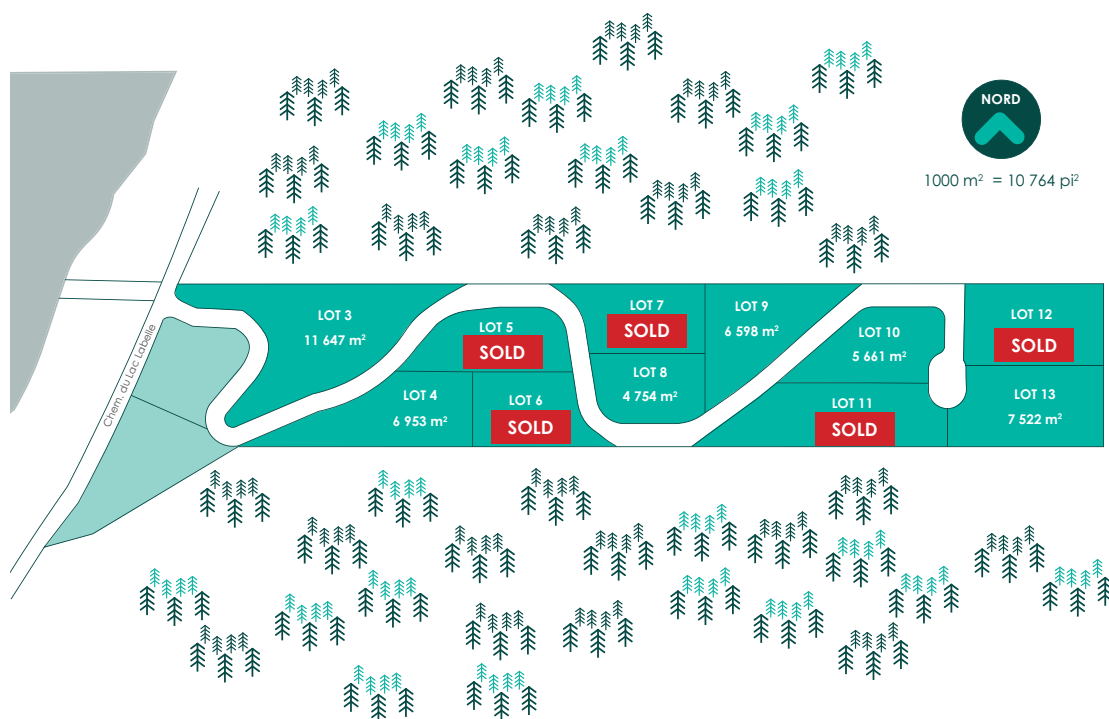

Quais du Sommet Labelle | Laurentides

A CHARMING ESTATE BETWEEN LAKE AND MOUNTAIN

Located 25 minutes from Mont-Tremblant and 90 minutes from Montreal, Quais du Sommet is a co-ownership project located in Labelle. The 6 lots still available have many advantages such as a dock space on Lake Labelle and the possibility of short-term rentals.



Lands	Area in ft ²	Prices*
3	125 372	\$188 058
4	74 850	\$149 000
8	51 178	\$154 000
9	71 028	\$173 000
10	60 936	\$196 000
13	80 968	\$165 000

* Taxes not included. Land prices do not include infrastructure costs. These include: Deforestation, the driveway, the excavation, the artesian well, the septic tank, the purification field, the underground connection to Hydro-Quebec and revegetation..)